



RADIAL LEADED POWER LINE CHOKES

YCAIRD 07 SERIES

FEATURES:

- High Saturation Material
- Polyolefin Shrink Tubing
- Low DC Resistance
- High Reliability Low cost

OPTIONS:

- Packaging: Tape & Reel is Standard (Qty: 1000 pcs)
Bulk packaging available for smaller quantities
- Tolerance: 10% is standard, tighter tolerances available.

COMMON APPLICATIONS:

- Switching Regulators
- RFI Suppression Filters
- Power Amplifiers
- Power Supplies
- SCR and Triac Controls
- Speaker Crossover Networks
- Automotive Systems
- Filters

PHYSICAL CHARACTERISTICS

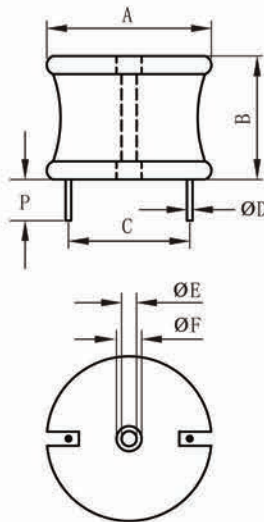

DIMENSIONS: inches/mm

A	B	P(min)	ØE	ØF
2.40/60.96	1.50/38.10	0.50/12.70	0.10/2.54	0.25/6.35

ELECTRONICAL SCHEMATIC

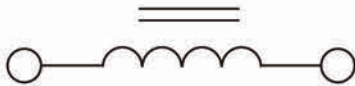

TECHNICAL INFORMATION:

The AIRD-05, 06, 07, 08, 04A, 06A, 08A Series of Power Line Choke is available in 367 standard values covering a wide range of inductance and current. The use of FAIRD04A-S21K high saturation flux density material makes these coils ideal for use in switching regulated power supply applications and wherever high current choke values in FAIRD04A-102K a small physical size are needed.

- Inductance Testing: HP4284A, HP4285A or equivalent
- RDC: QuadTech 1880 Milliohmeter FAIRD04A-122K
- Rated Current: L value drop 10% at IDC against its initial value
- Temperature rise 40°C Max Reference ambient temperature FAIRD04A-152K
- Solderability: 75% of the lead wire shall be covered
- Soldering Methods: Wave, Reflow
- Operating Temperature: -25°C to +85°C
- Storage Temperature: -55°C to +125°C
- Terminal bending strength: 24.5N Min
- Moisture resistance: $\Delta L/L \leq \pm 10\%$

Note: All specifications subject to change without notice.

STANDARD SPECIFICATIONS

Part Number	L (μ H) @1KHz	DCR (Ω Max)	IDC (A Max)	Dim C (Inches/mm) Approx.	Dim ØD (Inches/mm) Nom.
YCAIRD07-5R6M	5.6	0.0018	45.0	1.60/40.64	0.120/3.048
YCAIRD07-6R8M	6.8	0.0021	45.0	1.60/40.64	0.120/3.048
YCAIRD07-8R2M	8.2	0.0022	45.0	1.60/40.64	0.120/3.048
YCAIRD07-100K	10.0	0.0024	45.0	1.60/40.64	0.120/3.048
YCAIRD07-120K	12.0	0.0025	45.0	1.60/40.64	0.120/3.048
YCAIRD07-150K	15.0	0.0028	42.0	1.70/43.18	0.120/3.048
YCAIRD07-180K	18.0	0.0032	40.0	1.70/43.18	0.120/3.048
YCAIRD07-220K	22.0	0.0036	38.0	1.70/43.18	0.120/3.048
YCAIRD07-270K	27.0	0.0042	38.0	1.70/43.18	0.120/3.048
YCAIRD07-330K	33.0	0.0045	37.0	1.70/43.18	0.120/3.048
YCAIRD07-390K	39.0	0.0048	36.0	1.80/45.72	0.120/3.048
YCAIRD07-470K	47.0	0.0057	35.0	1.80/45.72	0.120/3.048
YCAIRD07-560K	56.0	0.0069	35.0	1.80/45.72	0.120/3.048
YCAIRD07-680K	68.0	0.0078	35.0	1.80/45.72	0.120/3.048
YCAIRD07-820K	82.0	0.0093	35.0	1.80/45.72	0.120/3.048
YCAIRD07-101K	100.0	0.0103	27.0	1.80/45.72	0.120/3.048
YCAIRD07-121K	120.0	0.0108	27.0	1.80/45.72	0.120/3.048
YCAIRD07-151K	150.0	0.0120	25.0	1.80/45.72	0.120/3.048
YCAIRD07-181K	180.0	0.0156	22.0	1.80/45.72	0.120/3.048
YCAIRD07-221K	220.0	0.0168	22.0	1.80/45.72	0.105/2.667
YCAIRD07-271K	270.0	0.0228	21.0	1.80/45.72	0.105/2.667
YCAIRD07-331K	330.0	0.0300	17.0	1.80/45.72	0.094/2.3876
YCAIRD07-390K	390.0	0.0432	13.5	1.70/43.18	0.084/2.1336
YCAIRD07-471K	470.0	0.0456	13.5	1.70/43.18	0.075/1.9050
YCAIRD07-561K	560.0	0.0480	13.5	1.75/44.45	0.075/1.9050
YCAIRD07-681K	680.0	0.0516	12.0	1.80/45.72	0.075/1.9050
YCAIRD07-820K	820.0	0.0648	11.5	1.80/45.72	0.075/1.9050
YCAIRD07-102K	1000.0	0.0936	10.0	1.75/44.45	0.068/1.7272
YCAIRD07-122K	1200.0	0.1020	9.50	1.78/45.212	0.068/1.7272
YCAIRD07-152K	1500.0	0.1176	8.00	1.80/45.72	0.068/1.7272
YCAIRD07-182K	1800.0	0.1536	7.50	1.70/43.18	0.060/1.5240
YCAIRD07-222K	2200.0	0.2160	7.20	1.70/43.18	0.054/1.3716
YCAIRD07-272K	2700.0	0.2424	6.00	1.75/44.45	0.054/1.3716
YCAIRD07-332K	3300.0	0.2640	5.50	1.80/45.72	0.054/1.3716
YCAIRD07-392K	3900.0	0.3480	5.20	1.75/44.45	0.048/1.2192
YCAIRD07-472K	4700.0	0.3924	5.00	1.78/45.212	0.048/1.2192
YCAIRD07-562K	5600.0	0.4320	4.70	1.80/45.72	0.048/1.2192
YCAIRD07-682K	6800.0	0.5940	4.50	1.70/43.18	0.043/1.0922
YCAIRD07-822K	8200.0	0.6600	4.00	1.75/44.45	0.043/1.0922
YCAIRD07-103K	10000.0	0.7560	4.00	1.80/45.72	0.043/1.0922
YCAIRD07-123K	12000.0	0.9840	3.50	1.80/45.72	0.039/0.9986
YCAIRD07-153K	15000.0	1.4160	2.80	1.75/44.45	0.035/0.8890
YCAIRD07-183K	18000.0	1.5240	2.80	1.78/45.212	0.035/0.8890
YCAIRD07-223K	22000.0	1.8000	2.30	1.80/45.72	0.035/0.8890
YCAIRD07-273K	27000.0	2.3760	2.00	1.75/44.45	0.031/0.7874
YCAIRD07-333K	33000.0	2.6400	1.90	1.80/45.72	0.031/0.7874
YCAIRD07-393K	39000.0	3.5760	1.60	1.75/44.45	0.028/0.7112
YCAIRD07-473K	47000.0	3.9360	1.60	1.78/45.212	0.028/0.7112
YCAIRD07-563K	56000.0	4.3200	1.50	1.80/45.72	0.028/0.7112
YCAIRD07-683K	68000.0	5.2200	1.30	1.85/46.99	0.028/0.7112